

**Preliminary Proposals:**

1. James Street: footway widening extend the existing two-way, shared use path from Hazel Court to Lawrence Street.
2. James Street/Lawrence Street Junction: provision of a Toucan with a central refuge to help pedestrians and cyclists cross to/from Regent Street under signal control.
3. Regent Street: route signing only.
4. Heslington Road: extend the existing cycle lanes and provide a refuge to help cyclists turn right into Wellington Street.
5. The Retreat: street lighting and direction signing to make this existing pedestrian/cycle route more attractive (subject to agreement with land owners).
6. University Campus: tie into existing cycle paths and signing

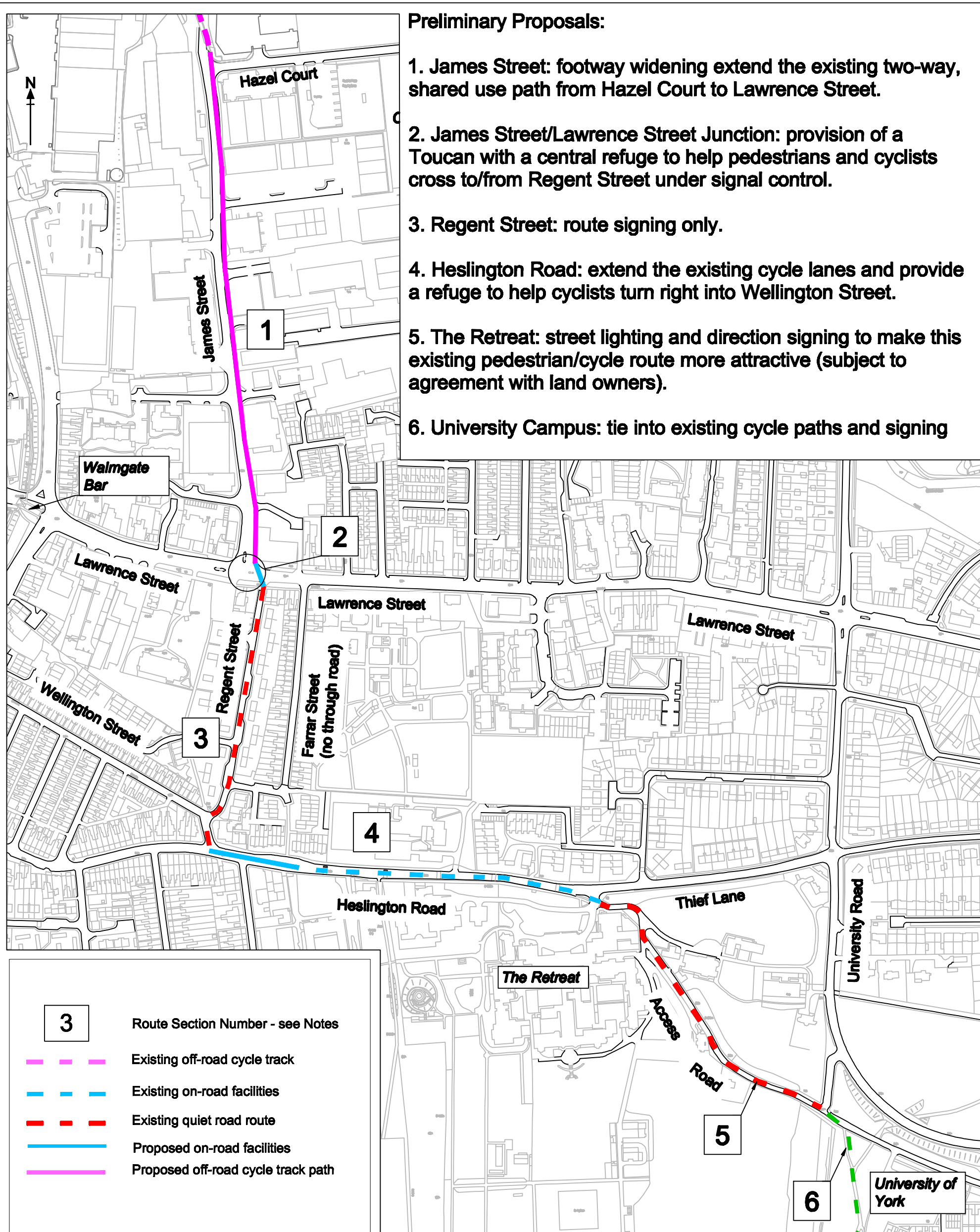

**York Consultancy**  
Consultants of first choice

**CITY OF YORK COUNCIL**

**Orbital Cycle Route: James Street to Heslington Road**

BASED UPON THE ORDNANCE SURVEY MAPPING WITH THE PERMISSION OF THE CONTROLLER OF HER MAJESTY'S STATIONERY OFFICE. CROWN COPYRIGHT. UNAUTHORISED REPRODUCTION INFRINGES CROWN COPYRIGHT AND MAY LEAD TO PROSECUTION OR CIVIL PROCEEDINGS, City of York Council, License No. 1000 20618

Drawn	Checked	Date	Scale	Drawing Number
PH	MM	08/01/2010	NTS	DEC/09010527